

**2" X 2" ISOWELD FASTENING PATTERN  
PERIMETER & CORNER ATTACHMENT  
TO MEET FM 1-150 GUIDELINES**

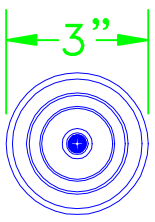

FLEX ISOWELD PLATE

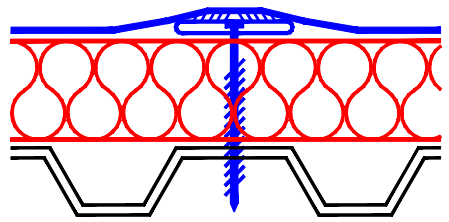

FLEX FASTENER AND ISOWELD PLATE

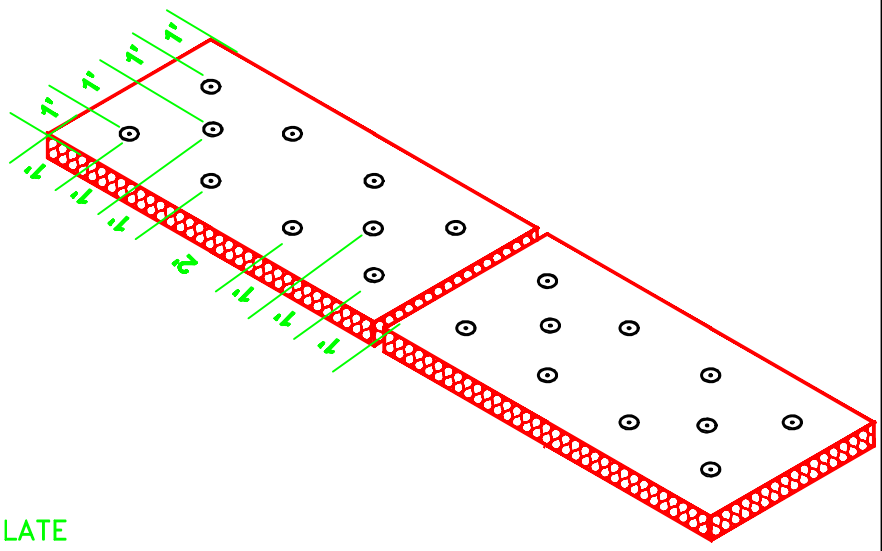

**NOTES:**

- 1) PERIMETER AND CORNER AREAS ARE DETERMINED IN ACCORDANCE WITH ASCE-7:  
 $\frac{1}{10}$  LEAST PLAN WIDTH OR  
 $\frac{1}{10}$  ROOF HEIGHT BUT NOT LESS THAN 4 FT.
- 2) BOARDS CROSSING PERIMETER/CORNER AREA INTO FIELD AREA SHALL BE ATTACHED ACCORDING TO RESPECTIVE PERIMETER/CORNER RATES.
- 3) FOR HEIGHT > 60 FT, CORNER IS "L" SHAPED WITH DIMENSIONS (2 X "PERIMETER").

TITLE	
FLEX TPO ISOWELD FASTENING 2X2	
NAME:	
DETAIL NO. I-3	
DRAWN BY:	DATE:
SK	8/2015
APPLICABLE TO FLEX TPO ISOWELD ATTACHED ROOFING SYSTEMS	
FLEX MEMBRANE INTERNATIONAL	2670 LEISCZ'S BRIDGE RD. LEESPORT, PA 19533 800-969-0108 FlexRoofingSystems.com