

**2' X 3' ISOWELD FASTENING PATTERN
PERIMETER & CORNER ATTACHMENT
TO MEET FM 1-90 GUIDELINES**

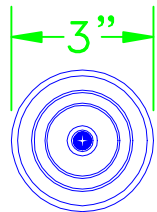

FLEX ISOWELD PLATE

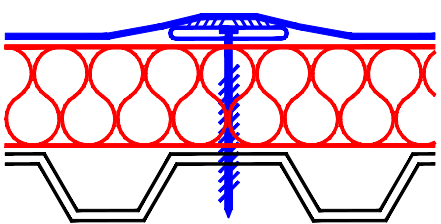

FLEX FASTENER AND ISOWELD PLATE

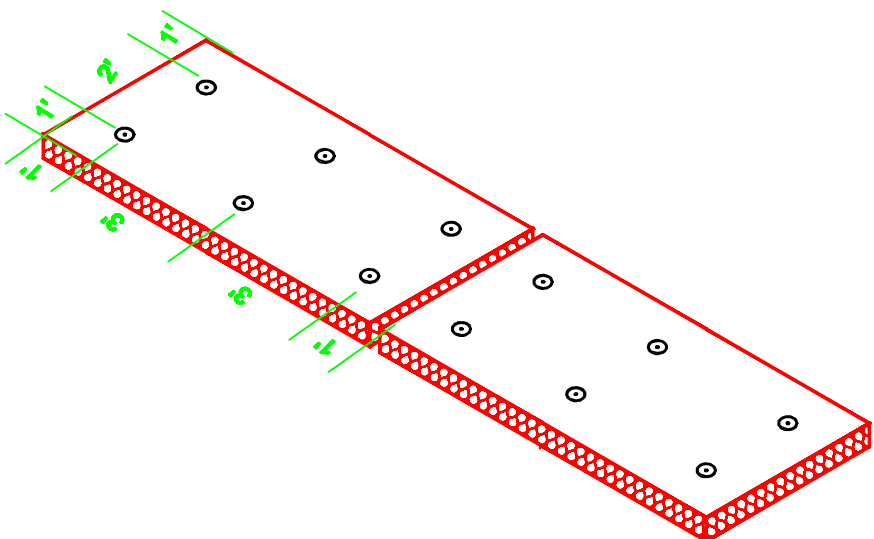

NOTES:

- 1) PERIMETER AND CORNER AREAS ARE DETERMINED IN ACCORDANCE WITH ASCE-7:
 $\frac{1}{10}$ LEAST PLAN WIDTH OR
 $\frac{1}{10}$ ROOF HEIGHT BUT NOT LESS THAN 4 FT.
- 2) BOARDS CROSSING PERIMETER/CORNER AREA INTO FIELD AREA SHALL BE ATTACHED ACCORDING TO RESPECTIVE PERIMETER/CORNER RATES.
- 3) FOR HEIGHT > 60 FT, CORNER IS "L" SHAPED WITH DIMENSIONS (2 X "PERIMETER").

TITLE FLEX ISOWELD 2X3 FASTENING	
NAME: DETAIL NO. I-2	
DRAWN BY: SK	DATE: 8/2015
APPLICABLE TO FLEX ELVALOY PVC AND TPO ISOWELD ATTACHED ROOFING SYSTEMS	
FLEX MEMBRANE INTERNATIONAL	2670 LEISCZ'S BRIDGE RD. LEESPORT, PA 19533 800-969-0108 FlexRoofingSystems.com