

**2' X 2' RHINO BOND FASTENING PATTERN
PERIMETER & CORNER ATTACHMENT
TO MEET FM 1-150 GUIDELINES WITH FLEX PVC AND ELVALOY
MEETS FM 1-120 WITH FLEX TPO**

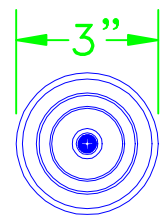

FLEX RHINO BOND PLATE

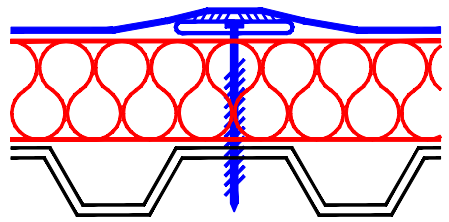

FLEX FASTENER AND RHINO BOND PLATE

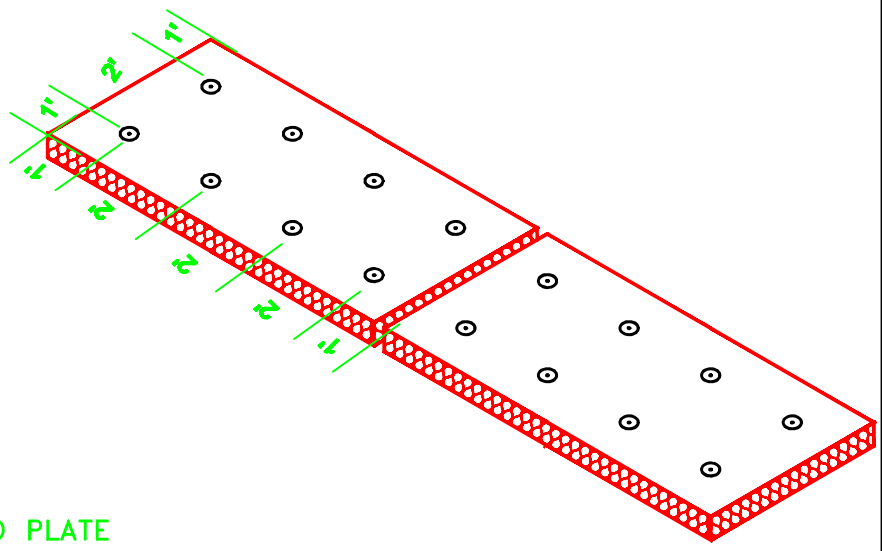

NOTES:

- 1) PERIMETER AND CORNER AREAS ARE DETERMINED IN ACCORDANCE WITH ASCE-7:
 $\frac{1}{10}$ LEAST PLAN WIDTH OR
 $\frac{1}{10}$ ROOF HEIGHT BUT NOT LESS THAN 4 FT.
- 2) BOARDS CROSSING PERIMETER/CORNER AREA INTO FIELD AREA SHALL BE ATTACHED ACCORDING TO RESPECTIVE PERIMETER/CORNER RATES.
- 3) FOR HEIGHT > 60 FT, CORNER IS "L" SHAPED WITH DIMENSIONS (2 X "PERIMETER").

| | | | |
|--|----|--|---------|
| TITLE | | FLEX RHINO BOND FASTENING 2X2 | |
| NAME: | | DETAIL NO. R-3 | |
| DRAWN BY: | SK | DATE: | 12/2013 |
| APPLICABLE TO ALL FLEX RHINO BOND ATTACHED ROOFING SYSTEMS | | | |
| FLEX MEMBRANE INTERNATIONAL | | 2670 LEISCZ'S BRIDGE RD. LEESPORT, PA 19533 800-969-0108 FlexRoofingSystems.com | |