

2' X 2' RHINO BOND FASTENING PATTERN
PERIMETER & CORNER ATTACHMENT
TO MEET FM 1-120 GUIDELINES

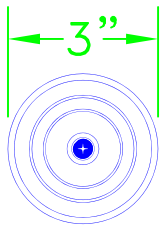

FLEX RHINO BOND PLATE

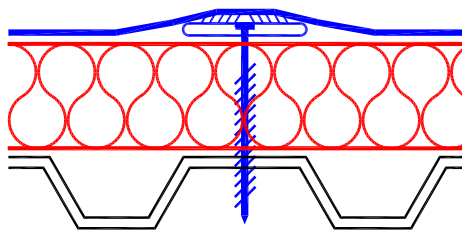

FLEX FASTENER AND RHINO BOND PLATE

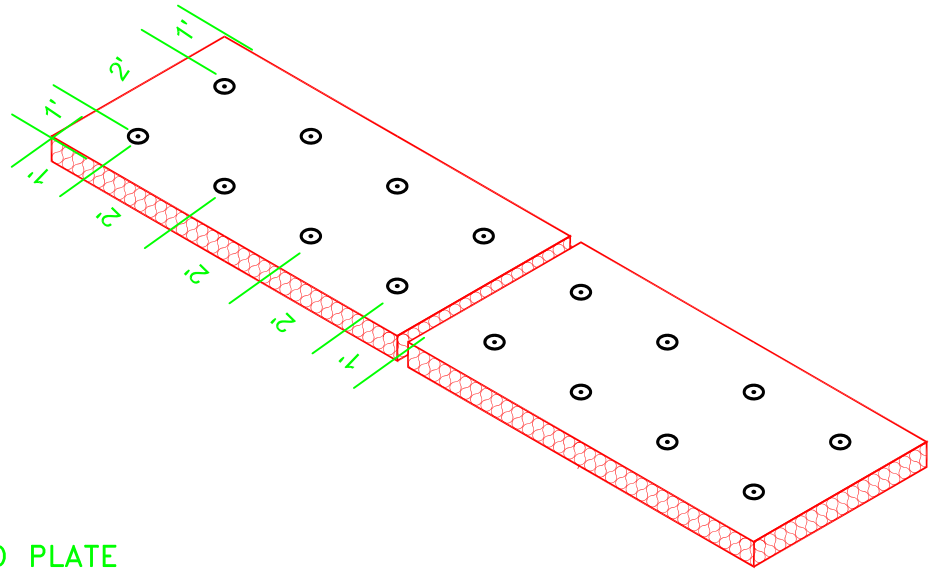

NOTES:

- 1) PERIMETER AND CORNER AREAS ARE DETERMINED IN ACCORDANCE WITH ASCE-7:
 $\frac{1}{10}$ LEAST PLAN WIDTH OR
 $\frac{1}{10}$ ROOF HEIGHT BUT NOT LESS THAN 4 FT.
- 2) BOARDS CROSSING PERIMETER/CORNER AREA INTO FIELD AREA SHALL BE ATTACHED ACCORDING TO RESPECTIVE PERIMETER/CORNER RATES.
- 3) FOR HEIGHT > 60 FT, CORNER IS "L" SHAPED WITH DIMENSIONS (2 X "PERIMETER").

TITLE	
FLEX RHINO BOND FASTENING 2X2	
NAME	
DETAIL NO. R-3	
DRAWN BY:	DATE:
SK	12/2013
APPLICABLE TO ALL FLEX RHINO BOND ATTACHED ROOFING SYSTEMS	
FLEX MEMBRANE INTERNATIONAL	2670 LEISCZ'S BRIDGE RD. LEESPORT, PA 19533 800-969-0108 FlexRoofingSystems.com