

# RetroDriller Fastener

## PRODUCT DATA SPECIFICATIONS

### PRODUCT DESCRIPTION

The Flex RetroDriller Fastener is designed for attaching single-ply membrane systems to structural steel purlins (up to  $\frac{3}{16}$ " in standing seam metal roof retrofit applications).

The Flex RetroDriller Fastener has a  $\frac{1}{2}$ -in. drill point that quickly drills into structural purlins. It is available in five lengths from 4-in. to 10-in. and is Factory Mutual approved.

### FEATURES & BENEFITS

- Depending on hardness/tensile of the purlins or bar joist, the Flex RetroDriller Fastener may be used on steel up to  $\frac{3}{16}$ -in. thick.
- Low profile head has a smooth surface to ensure that there is no damage to the membrane.
- F.M. approved.

### COATING

CR-10 corrosion resistant coating passes the corrosion requirements of FM Approval Standard 4470 and ETAG 006.

### APPLICATION

The Flex RetroDriller Fastener must penetrate through the purlin a minimum of 1-in.

Using a screw gun with a maximum of 1800 RPM, drive the fastener through the purlin until a slight depression is seen around the plate.

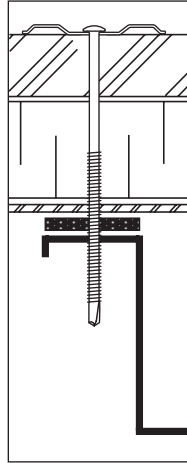

**Note: Caution should be taken not to overdrive the fastener causing stress plate surface to deflect more than  $\frac{1}{16}$ -in.** Prior to job bid, contact Flex to visit the job site for pullout test.

### PLATES & ACCESSORIES

Use 3-in. Flex RhinoBond (TPO, PVC and Elvaloy) stress plate or other plate as appropriate.



For best installation results, use a high torque, low RPM screw gun with a maximum of 1800 RPM.

### APPROVALS



**Flex**<sup>TM</sup>  
Thermoplastic Single Ply and Multi-Ply  
Roofing & Waterproofing Systems

800-969-0108 • 610-916-9501 (Fax)

5103A Pottsville Pike, Reading, PA 19605

e-mail: flexroof@cs.com • www.flexroofingsystems.com



USE  
WITH  
**P**  
DECK  
TYPES

### PHYSICAL DATA

The data below is constant for each Flex RetroDriller Fastener.

HEAD	THREAD
#3 Square .425" Diameter	.230" Diameter
SHANK	COATING
.194" Diameter	CR-10

### ORDERING INFORMATION

CAT. NO.	LENGTH	THREAD	PKG	WEIGHT
RDDP004B	4"	3"	500	19 lbs.
RDDP005B	5"	3"	500	21 lbs.
RDDP006B	6"	3"	500	25 lbs.
RDDP008B	8"	3"	500	32 lbs.
RDDP010B	10"	3"	500	40 lbs.

PL2900 Rev. 1016

Each Flex RetroDriller Fastener has a  $\frac{1}{2}$ -in. drill point. Fastener must be installed with a minimum 1" penetration through the purlin.

#### KEY:

<b>S</b> Steel	<b>SC</b> Structural Concrete
<b>W</b> Wood	<b>LC</b> Lightweight Concrete
<b>G</b> Gypsum	<b>LWIC</b> Lightweight Insulating Concrete
<b>P</b> Purlins	<b>CWF</b> Cementitious Wood Fiber

# RetroDriller Fastener

## PRODUCT DATA SPECIFICATIONS

### SPECIFICATION

The fastener will be an Flex RetroDriller Fastener with a nominal shank diameter of .194 and a thread diameter of .230. The Flex RetroDriller Fastener will be used with a Factory Mutual approved 3-in. round RhinoBond plate (TPO, PVC and Elvaloy) or other plate as appropriate. The fastener must be Factory Mutual approved and made in America.

### APPLICATION

Using a screw gun with a maximum of 1800 RPM, drive the Flex RetroDriller Fastener into the purlin until a slight depression is seen around the plate. The Flex RetroDriller Fastener must penetrate through the purlin a minimum of 1-in.

**Note: Caution should be taken not to overdrive the fastener causing the stress plate to deflect more than 1/16-in.** Prior to job bid, contact Flex to visit the job site and test the fastener.

### PHYSICAL DATA

The data below is constant for each Flex RetroDriller Fastener.

HEAD	THREAD
#3 Square .425" Diameter	.230" Diameter
SHANK	COATING
.194" Diameter	CR-10
	PACKAGING
	500/carton

### FLEX RETRODRILLER FASTENER LENGTH SELECTION PROCEDURE

Flex RetroDriller Fastener Length	Combined Thickness of Membrane and/or Existing Substrate
	Max. Total Thickness
4"	3"
5"	4"
6"	5"
8"	7"
10"	9"

**Flex**<sup>TM</sup>  
*Thermoplastic Single Ply and Multi-Ply  
Roofing & Waterproofing Systems*

800-969-0108 • 610-916-9501 (Fax)  
5103A Pottsville Pike, Reading, PA 19605  
e-mail: flexroof@cs.com • www.flexroofingsystems.com